

# Capatect-Dehnfugenprofile „Plus“ 6660, 6670

Special joint sealing profile for vertical expansion joints based on two reinforcing fabric stripes and a synthetic loop connection between both.

## Product Description

Field of Application	To form vertical expansion joints in the Capatect ETICS* systems A and B. *ETICS = External Thermal Insulation Composite System <i>Brit. term:</i> EWI = External Wall Insulation <i>Am. term:</i> EIFS = External Insulation and Finish System  <b>Type E:</b> For flush joints <b>Type V:</b> For joints in internal corners
Material Properties	<ul style="list-style-type: none"> <li>■ Expansion joint may be formed akurat</li> <li>■ Weather resistant</li> <li>■ UV resistant</li> <li>■ Recoatable</li> <li>■ Economic application in one operation</li> <li>■ Suitable for all insulation thicknesses</li> <li>■ With 1 gauge (Typ V) or two gauges (Typ E) for the following coatings</li> <li>■ Variable used for joint widths from 5-25 mm</li> <li>■ 10 cm wide reinforcing fabric strips on both sides</li> </ul>
Packaging/Package Size	Unit length 250 [ cm ] Carton with 25 units / 62.5 [ m ]
Storage	Horizontally, tensionless, protected from continuing solar irradiation, heating and mechanical stress and moisture.
Product No.	Typ E = 6660/00 Typ V = 6670/00

## Application

Substrate Preparation	ETICS does not bridge expansion joints of buildings. These joints have to be taken over into the insulation and all following coats. For functional and optical reasons the flanks of joints should be carried out carefully. For use of Capatect- Dehnfugenprofil "Plus" 6660 and 6670 set flank distances in minimum 5 mm and maximum 25 mm
Method of Application	Expansion joints (type E or type V) have to be carried out before applying the reinforcing layer. Apply reinforcement mortar on both sides of the joint about 15 cm wide spreaded over the insulation boards. Embed the fabric strips into the fresh reinforcing mortar. Take excess mortar of and smooth to avoid a piling on.

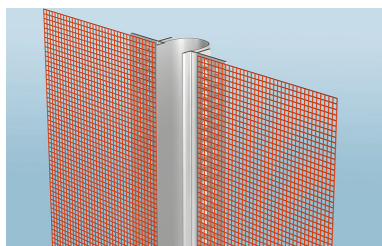

Consumption  
Application Conditions

**Recommendation:**

To ensure a uniform joint widths, insert a strip of polystyrene or comparably as spacer. This also prevents contamination of the joint profile while the following coatings are carried out. Separate the spacer carefully from each coat before curing. Remove the strip after completion of work.

per m: 1.0 [ m ]

See Technical Information of the used reinforcement mortar.

## Advice

Disposal

Dispose materials and all related packaging in a safe way in accordance with the full requirements of the local authorities.

Particular attention should be made to removing wastage from site in compliance with standard construction site procedures.

For EU: Dispose material residues as per EWC (European Waste Catalogue) 101103 (old glass fibre materials) or according to EWC 170904 (mixed construction and demolition waste).

Customer Service Centre

Tel.: +49 6154 71-71710

Fax: +49 6154 71-71711

e-mail: kundenservicecenter@caparol.de

International Distribution: Please see [www.caparol.com](http://www.caparol.com)

### Technical Information No. 6660 · Issue: July 2016

All suggestions and application instructions herein are based on our latest technical experience. Due to the wide variety of individual project conditions, we cannot be held responsible for their content. These instructions do not release the purchaser/ applicator from his responsibility to determine the suitability of the product in consideration of the project characteristics. These instructions are to be considered void when a new edition is released. Our general conditions of sale and delivery in their latest edition apply. This document is a translation of our German Technical Information No.6660 · Capatect-Dehnfugenprofile „Plus“ 6660, 6670 · Issued: January 2010